

## News Letter\_February.2018\_Monthly news

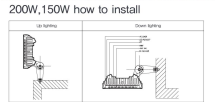

Monthly news
Dasha Buyer, who had a meeting with Japan Trade Mission in September last year, visited us on the 2nd of last week and held in-depth conversations.
Below the visit, they tested the product twice a sample of us already as confirmed the detailed specification of the actual production product and proceed the production site tour.
We will supply waterproof LED lighting for machine tools customized to the facility in the near future.



LED Flood lighting 150W

Big space lighting 150W

100% waterproof, flame proof, dust proof and anti-vandal lighting. Life expectancy 50,000 hours.

CE, FCC, RoHS, ENEC, SAA

1. STANDARD		2. Beam angle		CR	CCT
Total flux	Unit:lm	Beam angle	CR	CCT	
15,000lm	150W	22°/67°	67°/71°/120°	Over 90	5000K, 6500K, 3000K

Converter		Input	Output	Efficiency	IP
Model	Power	Power	Power	Efficiency	IP
150W	150W	150W	150W	95%	IP67

IP model		Material	Weight	Mounting	Material	Color
Model	Material	Weight	Mounting	Material	Color	Material
150W	Aluminum	1.5kg	150W	Aluminum	Aluminum	White

LED Flood lighting 200W

Big space lighting 200W

100% waterproof, flame proof, dust proof and anti-vandal lighting. Life expectancy 50,000 hours.

CE, FCC, RoHS, ENEC, SAA

1. STANDARD		2. Beam angle		CR	CCT
Total flux	Unit:lm	Beam angle	CR	CCT	
20,000lm	200W	22°/67°	67°/71°/120°	Over 90	5000K, 6500K, 3000K

Converter		Input	Output	Efficiency	IP
Model	Power	Power	Power	Efficiency	IP
200W	200W	200W	200W	95%	IP67

IP model		Material	Weight	Mounting	Material	Color
Model	Material	Weight	Mounting	Material	Color	Material
200W	Aluminum	1.8kg	200W	Aluminum	Aluminum	White

